

SERIE SPD

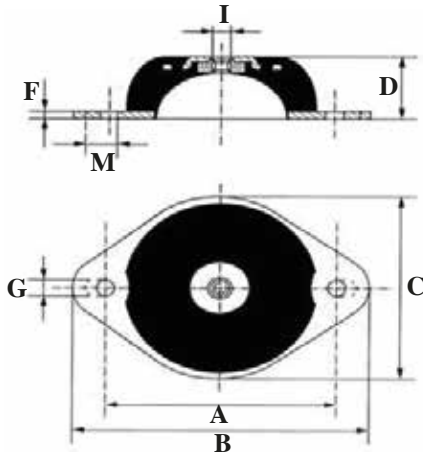

Questi antivibranti a forma di campana sono particolarmente indicati per isolare apparecchiature di precisione, quadri elettronici e strumenti particolarmente sensibili e delicati. Possiedono una forma elastica in senso verticale e limitata in senso orizzontale.

19-06-2015

ANTIVIBRANTE A CAPPELLO

CODICE	ARTICOLO	Durezza (IRHD)	A	B	C	D	F	G (xM)	I	Rigidezza media (Kg/mm)	Carico max (daN)	Defless. max (mm)	Peso kg
110.27.000 W	SPD 50 W	45 (40-45)	50	64	43	20	2	7	M6	1,5	4,5	3,0	
110.27.000 M	SPD 50 M	60 (55-60)								3,0	9,0	3,0	
110.27.000 H	SPD 50 H	70 (65-70)								5,5	18,5	3,0	
110.27.001 W	SPD 65-73/8 W	45 (40-45)	65/73	88	59	25	2,5	8x12	M8	4,0	26,5	7,5	
110.27.001 M	SPD 65-73/8 M	60 (55-60)								6,0	43,0	7,5	
110.27.001 H	SPD 65-73/8 H	70 (65-70)								10,0	75,0	7,5	
110.27.002 W	SPD 65-73/10 W	45 (40-45)	65/73	88	59	25	2,5	8x12	M10	4,0	26,5	7,5	
110.27.002 M	SPD 65-73/10 M	60 (55-60)								8,0	43,0	7,5	
110.27.002 H	SPD 65-73/10 H	70 (65-70)								12,0	75,0	7,5	

ANTIVIBRANTE A CAPPELLO -- VERSIONE RINFORZATA

110.27.003 W	SPD-R 76/8 W	45 (40-45)	76	100	70	27	3	7	M8	15,0	75,0	5,0	
110.27.003 M	SPD-R 76/8 M	60 (55-60)								24,0	120,0	5,0	
110.27.003 H	SPD-R 76/8 H	70 (65-70)								35,0	170,0	5,0	
110.27.004 W	SPD-R 92/10 W	45 (40-45)	92	115	76	35	2	10	M10	7,0	40,0	5,6	
110.27.004 M	SPD-R 92/10 M	60 (55-60)								11,0	60,0	5,6	
110.27.004 H	SPD-R 92/10 H	70 (65-70)								24,0	135,0	5,6	

Descrizioni e caratteristiche tecniche indicative e non impegnative